

# 3310 Drum Chipper

A big chipper in a small package.

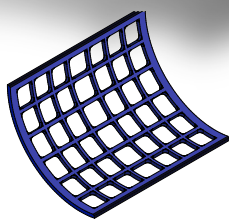

Can ship in a high-cube container.



## Superior Product Sizing

Peterson's grate system provides ultra-consistent chip sizing; twigs and small stems which can be difficult to size are easily fractured through our innovative system.

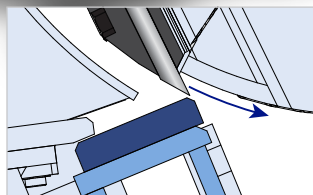

## Innovative Anvil Design

The robust, two-sided anvil is easily serviced through an access panel from ground level. Adjusting the anvil position can be completed by one person in a matter of minutes.

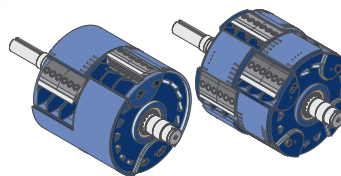

## 4- or 8-Pocket Drums Available

Featuring durable AR400 wear surfaces, the 3310 comes standard with a 4-pocket drum rotor with one babbitted knife per pocket. An 8-pocket drum rotor is available for chipping microchips.

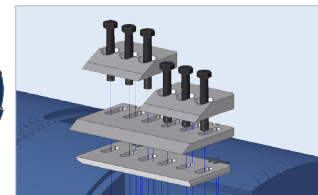

## Heavy-Duty Knife Assemblies

Produced from the highest quality alloy chromium steel, heavy-duty Peterson knife assemblies achieve uniform production of wood chips with high accepts and minimal losses.

## Peterson's all-new 3310 Drum Chipper is a radical departure from traditional drum chippers.

With a 540 hp (402 kW) Caterpillar engine, the 3310 has the power to handle up to 24-inch (61 cm) diameter logs. The fully enclosed engine compartment keeps things clean, but easily serviced by large access doors on both sides of the machine.

The 3310's transverse design allows for a much smaller operations deck, and the rotatable end load or optional top load spout design allows for trailers to be loaded in a

variety of positions, depending on the demands of the job site.

Using the proven drum and knife design used on the larger 4300-series drum chippers, the 3310's main components are robust and offer long life.

The 3310 is available with a four-pocket drum for typical biomass chips, or a eight-pocket drum for microchipping applications. The chips exit the machine from an innovative auger system which feeds an accelerator to increase payload density.



Designed for international markets, the 3310 can be easily transported in a high-cube, 40-foot container, significantly saving on shipping expense.



**Peterson**  
an Astec Industries Co.

## 3310 Dimensions

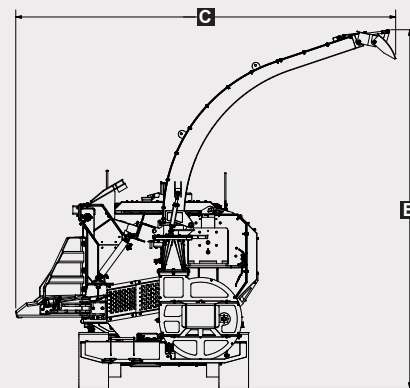
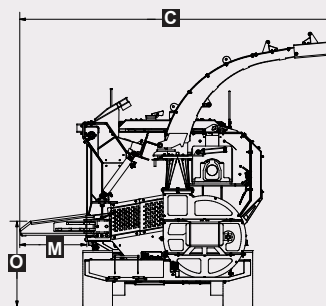
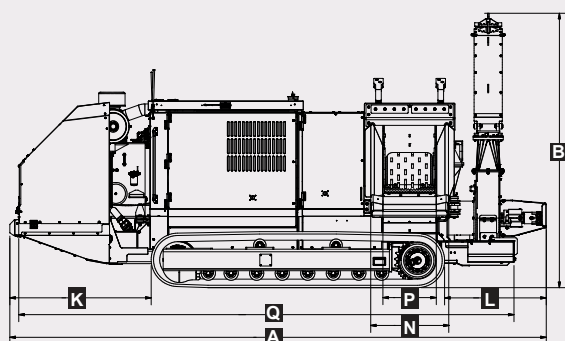

Optional Top Load Spout  
and Feed Deck Wings

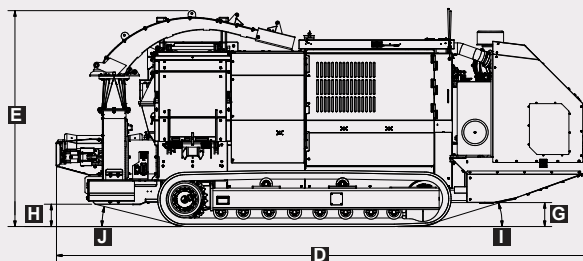
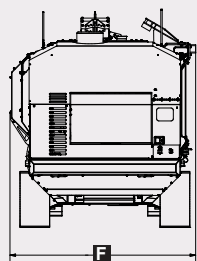

## 3310 Specifications

### Dimensions

A Operating Length	15' 10" (484 cm)
B Operating Height	16' 10" (513 cm)
C Operating Width	23' 9" (724 cm)
D Travel Length	10' 11" (333 cm)
E Travel Height	
F Travel Width	
G Front Ground Clearance	
H Rear Ground Clearance	
I Front Clearance Angle	
J Rear Clearance Angle	
K Front Overhang	
L Rear Overhang	
M Feed Deck Length	
N Feed Deck Width	
with Feed Deck Wings (Optional)	
O Feed Deck Height	
P Feed Width	
Q Frame Length	

### Top Load Spout

### Standard

23' 9" (724 cm)
12' 2" (370 cm)
13' 10" (422 cm)
23' 9" (724 cm)
9' 7" (292 cm)
8' 3" (251 cm)
1' (30 cm)
1' (30 cm)
17°
14°
6' 3" (191 cm)
4' 6" (137 cm)
3' (91 cm)
3' 5" (104 cm)
5' 6" (168 cm)
3' 9" (114 cm)
2' 4" (71 cm)
21' 11" (668 cm)

### Tracks

Track Type and Width	triple grouser, 16" (40 cm)
Travel Speed	1.0/2.0 mph (1.6/3.2 kph)
Ground Pressure	12.6 lbs/in <sup>2</sup> (0.89 kg/cm <sup>2</sup> )

### System Controls

Peterson Adaptive Control System
Radio Remote
Peterson <sup>+</sup> Analytics

### Feed System

Feed Opening	24" h x 28" w (61 x 72 cm)
Feed Rolls	2 rollers, 10.5" dia (27 cm)
Internal Drive Compression Roll	28" dia (71 cm)
Feed Rate	up to 160 ft/min (4876 cm/min)

### Chipper

Drum Size	36" dia x 32" w (91 x 81 cm)
Knife Pockets	4 or 8 pockets
Knife Type	babbitt

### Production

Chip Output*	60 to 100 tons/hour (54 400 to 90 700 kg)
*Actual output may vary due to wood species, chip size, moisture content, and support equipment. Production rates are based on operating 50 minutes/hour.	

### Optional Equipment

Multiple Knife Options	1/8" to 1 1/4" (3 to 32 mm) chip lengths
LED Work Lights	
Top Load Spout*	
Feed Deck Wings*	

\*Options effects dimensions, weight, and ground pressure.

Measurements are rounded to the nearest whole increment. Specifications subject to change without notice.

### Weight

Machine Weight*	44,000 lbs (19 958 kg)
-----------------	------------------------

\*Varies based on optional equipment and machine configuration.

### Powertrain

Engine	Caterpillar C15 Tier III or Tier IV
Horsepower	540 hp (402 kW)
Clutch	PT Tech SCT2500
Fuel Tank Capacity	230 gallons (871 L)
Main Hydraulic Tank Capacity	90 gallons (341 L)
Diesel Exhaust Fluid Tank Capacity (Tier IV Only)	12 gallons (45 L)

**PETERSON** an Astec Industries Company

PO Box 40490 • Eugene, OR 97404 • Tel 800.269.6520 Fax 541.689.0804 • www.petersoncorp.com

